

EN User manual

USER MANUAL

Portable Air Conditioner

Model No.:
ZPM10CRA-D1
ZPM10HRA-D1
ZPM12CRA-D1
ZPM12HRA-D1

ZANUSSI

1 welcome

Welcome to the world of simple handling and no worries.

Thank you for choosing Zanussi. This manual contains all of the information required to guarantee your safety and the appropriate use of your portable air conditioner.

Please read all of the instructions before using the portable air conditioner and keep this manual for future reference.

We know you will enjoy your new portable air conditioner and thank you for choosing our product. We hope you will consider us for future purchase.

Environmental Advices

The packaging material used is recyclable; we recommend that you separate plastic, paper and cardboard and give them to recycling companies.



Contents

Safety	3
Product description	5
Installation	7
How to use	12
Cleaning and maintenance	25
Troubleshooting	28
Technical specifications	30

3 safety

Safety



Attention

This appliance is not intended for use by people with disabilities, sensory or mental capabilities (including children), or people with lack of experience and knowledge, only if they have been instructed in the use of the apparatus, or under supervision of a responsible person for their safety. Children should be supervised to ensure that they are not playing with the device.

Do not let your appliance to be tampered by children, even when off.

Keep the packaging materials out of reach of children. Make sure children do not play, hand or stay next to the product during operation and even off. This product should be handled only by adults.

For users and installers

Before you start cleaning or maintenance of your Air Conditioning, disconnect the plug and do not pull on the cord. If the cord is damaged, it must be replaced by Zanussi Authorized Service in order to avoid risks. Even to avoid risks, do not turn on, twist, or attempt to tie the cord. Be careful that the air conditioning does not stand on the power cord.

This product must be grounded. In case of malfunction or breakdown, grounding reduces the electric shock. This product has a power cord with grounding connection equipment and a connection pin.

Incorrect connection of the grounding equipment can result in a risk of electric shock.



Attention

If you have questions about grounding, contact a qualified electrician who does not modify the plug of the power cord (supplied with the product) if it will not fit in the outlet. Ask an electrician to install the plug to a grounded.

This Air Conditioner should be used only for domestic use, and any other use is dangerous, and the manufacturer is not responsible for any damage caused by improper or incorrect use. As such, always follow the instructions in this manual.

Do not place objects on the device.

Do not install the appliance in rooms containing gas, oil or sulfur, nor near heat sources.

Keep a distance of 50 cm from flammable substances (alcohol, etc.) or pressurized containers (such as canned aerosols, etc.)

Avoid using appliances near the air conditioning heating.

Always transport the appliance in the upright position. Before moving, remove all water from the internal circuit. After moving the appliance, wait at least 1 hour before turning it on again.

When storing the device, do not cover it with plastic bags.

Under no circumstances should you alter the characteristics of the device, as this will result in loss of warranty.

If this air conditioner does not work, remove the power cord from the wall outlet and do not touch the product. Contact Zanussi Authorized Service.

Do not pull the product by the power cord.

Attention

Never carry this device in leaning position, side or up side down. Never lean over 60°.

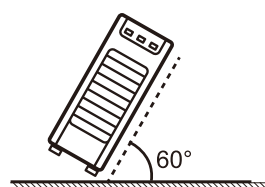

Attention

When using the front handle, never place your hands on the vents, as it can damage them.

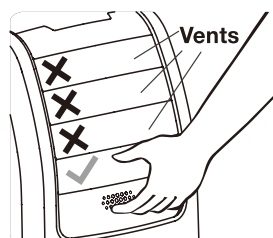

5 product description

Product description

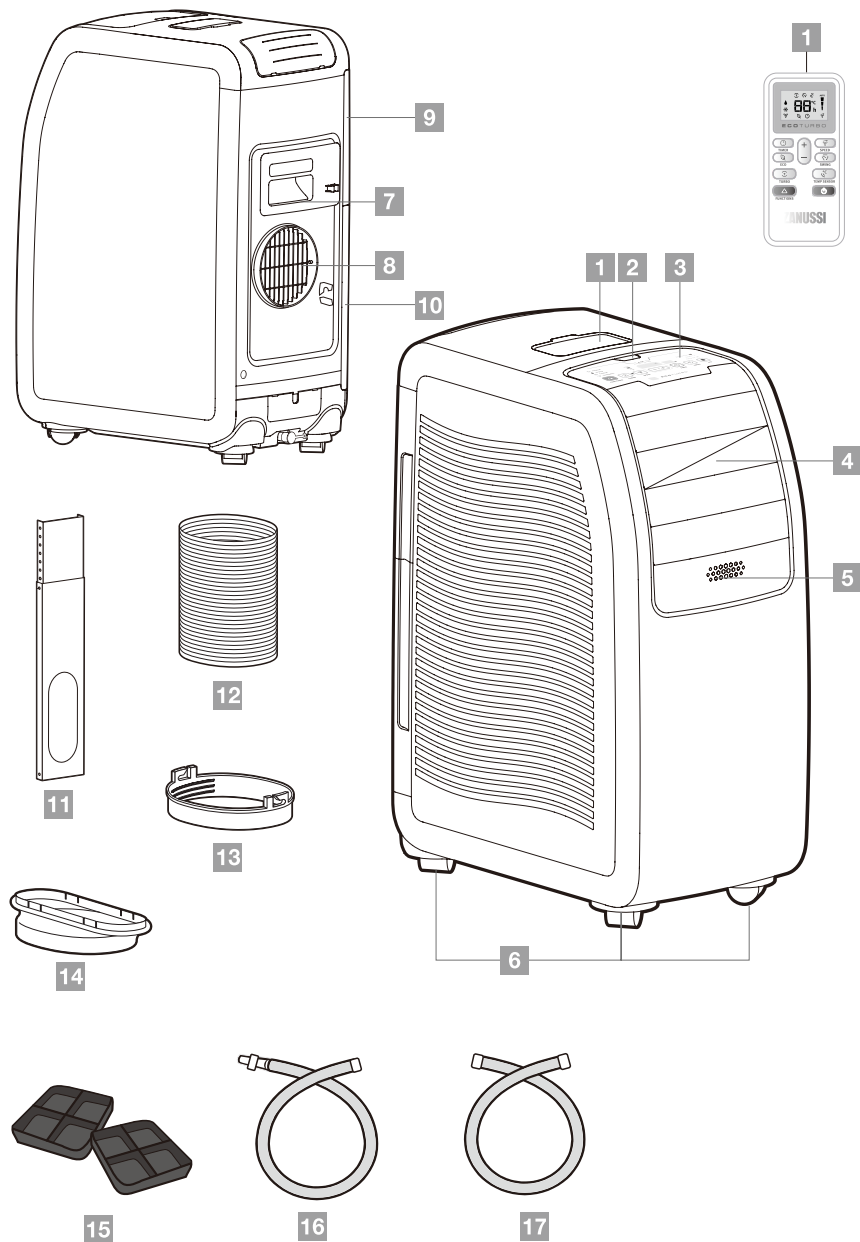

Parts names

- 1** Remote Control *
- 2** On / off button
- 3** Control Panel
- 4** External Grilles
- 5** Handle with retractable front cover
- 6** Wheels
- 7** Power cord support
- 8** Connection to the exhaust pipe
- 9** Top Filter (evaporator)
- 10** Bottom filter (capacitor)
- 11** Window adapter
- 12** Exhaust duct
- 13** Connector hose to the appliance
- 14** Window adapter connector
- 15** Fixing pan
- 16** Drain hose with quick coupling plug (only in heat and cool models)
- 17** Gravity drain hose (only in some models)

** Please contact an Authorized Service centre for installation accessories of different sizes.*



Attention

The portable air conditioner you have just purchased may be slightly different from the one shown in the drawings in this manual, but its overall design is the same.

7 installation

Installation

Electrical installation

Before switching on, make sure if the voltage of the switch where the product is connected is equal to what is stated on the label next to the switch (on the power cord) or identification tag of the Air Conditioning.

If the device is not connected to the correct voltage, it will emit an audible beep alert signal and the light will start flashing on the control panel, and the unit will stop working. If you tap any key, the device will emit a beep sound.

Turn on your air conditioner in an exclusive switch; do not use extensions or type T (multiple) connectors. This type of connection may overload the power supply, impairing the function and resulting in accidents.

This unit must be grounded.

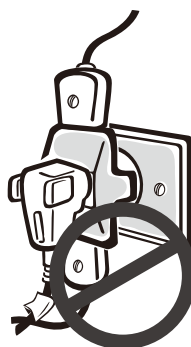

Attention

The plug on the portable air conditioner you have purchased may be different from the one shown in the manual, as the plug that accompanies the product meets your country's electrical specifications.

Installing the appliance

See next how to install your air conditioning so that it can move to another room as your need.

1. Pre-mount the connector to the exhaust pipe by turning the connector counterclockwise (clockwise) direction.
2. Fit the connector on the rear of the unit and turn it anti-clockwise to secure sense.
3. Position the adapter window and adjust the length to the pin.

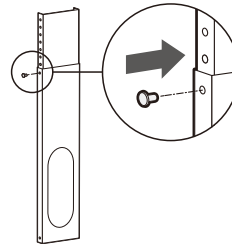
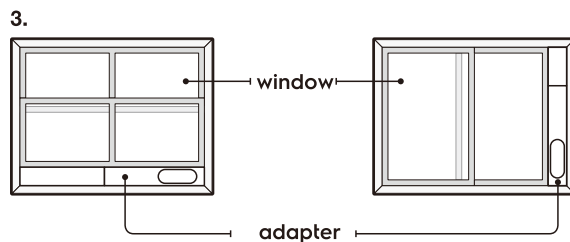
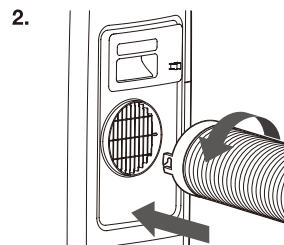
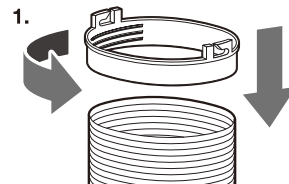

4. Pre-mount the connector of the window, turning the connector counterclockwise (clockwise) direction.
5. Fit the connector to the window adapter.
6. Make sure the exhaust pipe is not clogged.
7. If needed, use fastening bracket under the front wheels to prevent the device from moving.
8. If necessary, use bras with cups to maintain well positioned windows.

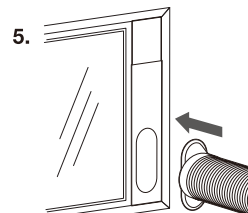
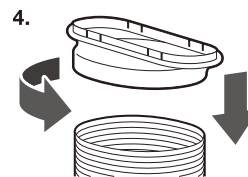

9 installation



Attention

Keep the exhaust pipe as short as possible, and preferably, no curves.
For the use of air conditioning, the installation of an exhaust pipe is mandatory.
Do not block the outlet of the exhaust pipe.

Minimum distance to the air inlet

On the left side of the apparatus, are the filters. It's from this side that your Portable Air Conditioner sucks air from the environment and cools it. In order for your unit to work properly with high performance and low power consumption, you should keep the minimum distance of 15cm between that side and the nearest object or wall.

Improper installation will shorten the life of the appliance

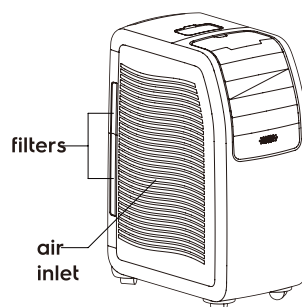

Auto evaporation

The cool and heat and cool models, when in the "cooling" or "Dehumidification" mode have a self-evaporation system, that is, during operation in these modes, any water generated is evaporated and removed through the exhaust tube. Therefore, in these circumstances you will not have to empty the tank, because of the alarm 'Empty'. Except in extreme weather situations, where the relative humidity is relatively high.

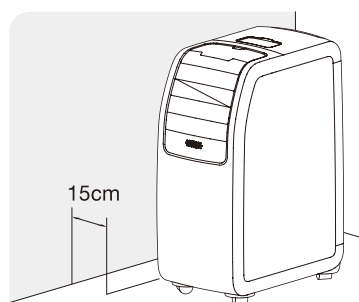

Water drainage method

As a precaution, and to prevent leakage of water, the air conditioning has a safety device that is activated when the water tank is full. The device stops working, the control panel displays the Empty tank indicator and the compressor and the fan will not restart until the tank has been emptied.

Intermittent drainage

Turn off the air conditioning and drain the water from the tank by removing the drain cap and allowing water to flow into the collector. The collector does not have capacity to store all the water in the tank, for that you will need to empty it as often as needed. To facilitate after filling 3 or 4 times the collector* and to prevent leakage, while moving the device, you can take it outside its residence, remove the drain cap and drain the water on the floor freely.

The drain will be considered sufficient when no more water is coming out. To fully drain the water tank, tilt the device slightly upwards from the front until no more water comes out. Do not tilt the appliance more than 60°.

**Drainage hose: present only in heat and cool models.*

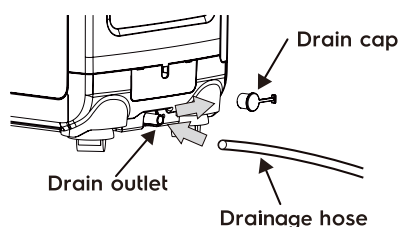
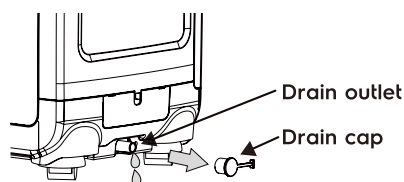

Restart the Air Conditioning by pressing the On/Off button. Make sure the unit is in the Cooling, Drying or Heating* (**only in some models*) mode. The compressor will start approximately 3 minutes after the unit is connected.

11 installation

Continuous drainage by gravity

This drainage can be applied in the *cool* and *heat and cool* models. Continuous gravity drainage mode can be used to avoid having to empty the tank of the apparatus.

Empty the water tank completely. Connect one end of the drain hose at the outlet, and let the other end outside the room or direct it to a place where water can be drained freely. Turn on the unit.

When the continuous gravity drainage method is used in the heating mode, the water removed from the air flows through the drain hose continuously.

Check that the height of the drain hose is not above the drain, otherwise, the water cannot be drained.

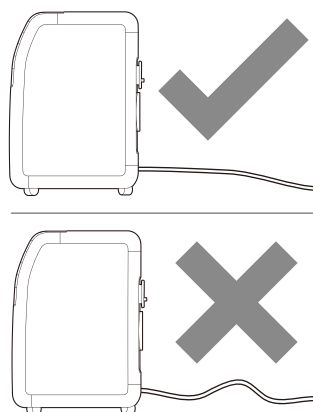

Continuous drainage through the drain pump (only in heat and cool models)

Heat and cool devices have a system of auxiliary drain with drain pump. To use it, connect the hose with quick hitch on the connection, as shown in the figure. Direct the other end of the hose in the area where water can be eliminated. In this mode, the height of the drain hose can be positioned at 1.5m above the floor.

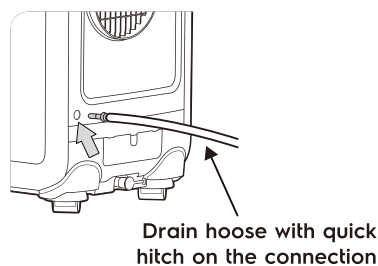

How to use

Control panel

Cold models

ZPM10CRA-D1

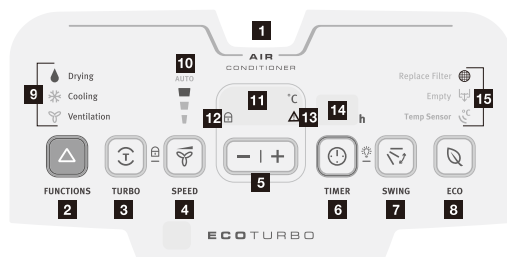

ZPM12CRA-D1

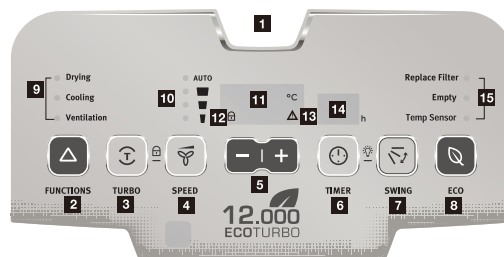

Heat and cold models

ZPM10HRA-D1

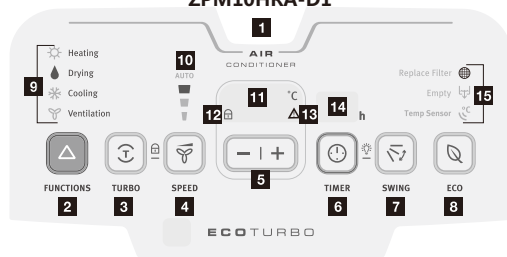

ZPM12HRA-D1



- | | |
|--------------------------------------|---|
| 1 On / Off button | 9 Description of functions |
| 2 Functions button | 10 Fan speed indicators |
| 3 Turbo button | 11 Temperature indicator |
| 4 Fan speed button | 12 Lock panel indicator |
| 5 Temperature settings button | 13 Error Alert |
| 6 Timer button | 14 Time Indicator |
| 7 Swing button | 15 Filter change, Empty tank and |
| 8 Eco button | Temp Sensor indicators |

13 how to use

Turning on the device

1. Place the power switch cord into the outlet. All lights will turn on the control panel, and the product will emit a long beep sound.
2. Press the On/Off button to power up. The last setting made will appear on the display informing when the device was turned off.

Note: in some situations, the device may take approximately 3 minutes to start the function

Selecting a function

Tap the Functions key: Each tap in this key selects functions in the following sequence: Ventilation → Cooling → Drying → Heating (only in some models) → Ventilation.

The indicator of the selected function lights on the control panel.

Ventilation

When the function Ventilation is selected, it is not possible to set the temperature.

When this function is first selected, the fan speed is automatically set to the level 1  .

Cooling

When this function is selected for the first time, the machine automatically sets the fan speed on level 1  and the temperature at 20°C.



FUNCTIONS

 Heating

 Drying

 Cooling

 Ventilation

Drying

When the Drying function is selected, it is not possible to program the Turbo mode, fan speed and temperature.

When this function is selected, the unit automatically sets the fan speed in AUTO mode .

Heating function (only in heat and cool models)

When this function is selected for the first time, the machine automatically sets the fan speed on level 1  and the temperature was set to 25°C.

Turbo mode

The turbo mode is combined with the Ventilation or Cooling function allows the unit to automatically adjust to get the best performance.

When the turbo mode is programmed, it is not possible to program the Eco mode.

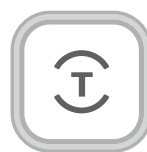

TURBO

Turbo Mode + Ventilation function

Select the Ventilation function and tap the Turbo button. In this mode the unit automatically sets the fan speed on level 3 .

To alter the speed of the fan, first turn off the Turbo mode. In this case, the program returns to the initial temperature and speed settings before selecting the Turbo mode.



FUNCTIONS



TURBO



Ventilation

Turbo mode + Cooling function

Select the Cooling function and tap the Turbo button. In this mode the unit automatically sets the fan speed on level 3 .

To alter the speed of the fan or temperature, first turn off the Turbo mode. In this case, the program returns to the initial settings before selecting the Turbo mode.



FUNCTIONS



TURBO



Cooling

Turbo mode + Heating function (only in heat and cool models)

Select the heating function and tap the Turbo button. In this mode the program automatically fan speed on level 1  system and increases the temperature to 28 °C.

To alter the speed of the fan, first turn off the Turbo mode. In this case, the program returns to the initial temperature and speed settings before selecting the Turbo mode.



FUNCTIONS



TURBO



Heating

Setting the fan speed

To change the fan speed, tap the Speed button. Each tap in this key selects the speed of the following sequence:

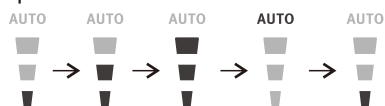

SPEED

In the Drying function is not possible to change the fan speed. In this case the standard speed is AUTO .

Setting the temperature in the cooling mode

To increase or decrease the temperature of the cooling, tap the keys - or +. Every touch on the keys increases or decreases the temperature by 1°C.

It is not possible to alter the temperature in the Ventilation and Drying the functions.



Setting the temperature in heating mode (only in heat and cool models)

To increase or decrease the temperature of cooling or heating, tap the keys - or +. The temperature can be adjusted between 18°C and 20°C. Every touch on the keys increases or decreases the temperature by 1°C.

You cannot alter the temperature in the Ventilation and Drying functions.



Setting the timer function

Use the Timer function to set an amount of time before the unit turns off automatically. This function can be used with all other functions.

Each tap in the Timer key selects an amount of time, in hours, as the following sequence:

1. Select the desired amount of time and wait 2 seconds.

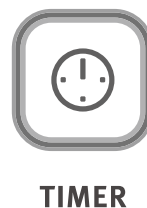

17 how to use

2. Then, the selected time blinks 3 times in the Timer display and the unit emits a short beep to confirm programming.

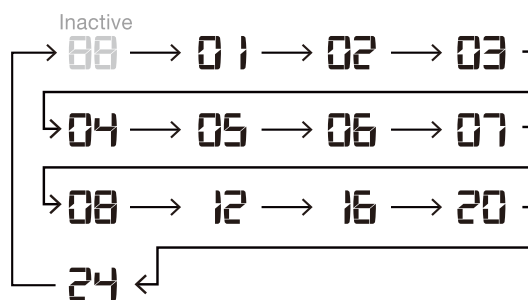

3. The selected time is displayed on the display and the machine starts the countdown to disconnect count.

Cancelling the Timer function

To cancel programming the Timer function, tap the Timer button. The unit will continue to operate in the prior schedule.



TIMER

Swing mode

Tap the Swing button to start the vertical movement of the front air vents and spread evenly on the environment.

To cancel this mode, tap the Swing key again.

To adjust the grids tap the Swing key in the desired position.

Do not adjust the grids manually.

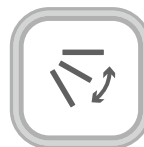

SWING

Eco mode

Tap the Eco button to select the mode and energy economy. This feature is ideal for driven before you go to bed as it satisfies the reduction of human metabolism during sleep, avoiding that you feel hot or cold while sleeping.

Using this function during the day makes the energy consumption is reduced.

When Eco mode is selected, the device gradually decreases its power within 8 hours. After this period, the unit turns off automatically. To select this mode, tap the Eco button

When Eco mode is programmed is only possible to alter the temperature and select the Swing mode. The other functions are unavailable.

To program the other functions, first you need to cancel the Eco function. To do this, tap the Eco button again.



ECO

Blocking the control panel

You can freeze the control panel to prevent accidental programming or cancellations. For this, keep your fingers on the Turbo and Speed buttons simultaneously for 2 seconds. The device will emit a long beep and the blocked panel indicator lights on the panel.



TURBO



SPEED

19 how to use

This option does not interfere with the function of the device.

While the panel is locked, if you try to make any alteration in the programming, the device will emit 2 short beeps, indicating that programming was not accepted.

To unlock the control panel, keep your fingers in the Turbo and Speed buttons simultaneously for 2 seconds again.

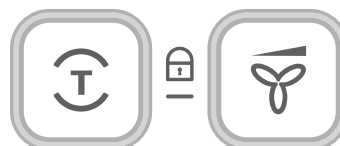

TURBO

SPEED

Turning off lights - control panel

To turn the lights on the control panel, keep your fingers on the Timer and Swing buttons simultaneously for 2 seconds. The device emits a long beep and all lights on the control panel go off.

While this feature is enabled, you can make programming changes. In this case, the lights come on temporarily after 5 seconds with no key is touched, the lights automatically turn off.

This option does not interfere with the operation of the apparatus, only now energy.

To turn the lights again, keep your fingers on the Timer and Swing buttons simultaneously for 2 seconds again.

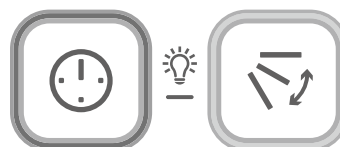

TIMER

SWING

Replace filter indicator

After about 2000 hours of use of the apparatus, Replace Filter Indicator lights on the control panel and the unit beeps 3 short beeps. This alert indicates that the filter must be replaced by a new one.

To turn off the alert after the filter was changed, keep your fingers on the keys - or + simultaneously for 2 seconds. Then, the unit will start the countdown to the next change.

This time is estimated based on a use of 8 hours per day, 5 days per week for 12 months.

In more severe conditions of use, the filter must be replaced more often.

Once a week the cleaning blade filter as indicated on this user manual.

Replace Filter



Empty tank indicator

After some time of use, the apparatus accumulates water in the reservoir located at the bottom.

This device has an electronic sensor that tells you when the tank is full. When this occurs, the Empty indicator lights on the panel and the unit beeps 3 short beeps.

The indicator turns off as soon as the tank is empty.

To run the drain, see Cleaning and Maintenance section of this manual.

Empty



21 how to use

Turning off the audible beeps

You can turn off the beeping of your Air Conditioning. To do this, hold your finger on the Eco button for approximately 2 seconds until you hear a short beep. To allow the beeps again, keep your finger on the Eco button for 2 seconds.



ECO

Temp Sensor function

The remote control works as a remote temperature sensor, allowing control of the temperature in the room where is the remote control.

To activate the Temp Sensor feature, point the remote at the unit and press the Temp Sensor button. The remote sends a signal to the air conditioner at each interval of 3 minutes, until the Temp Sensor button is pressed again. If the device does not receive the signal from the remote control after a time interval, the function is deactivated and the Temp Sensor icon of the indoor unit turns off.



Temperature scale °C or °F

Your portable Air Conditioning, can display temperature in °C (degrees Celsius) or °F (degrees Fahrenheit). If you need to alter the temperature shown in the display from °C to F, or vice versa, you must:

1. Turn off the product in the ON / OFF button, but keep it plugged into the outlet
2. Press and hold the 'FUNCTIONS' button on the panel for 10 seconds. The product will perform 3 short beeps;



FUNCTIONS

3. When reconnecting, the temperature scale, have been altered.

Scale of temperatures shown in the panel when it is set to:

°C: 18-28

°F: 64-83

Remote control

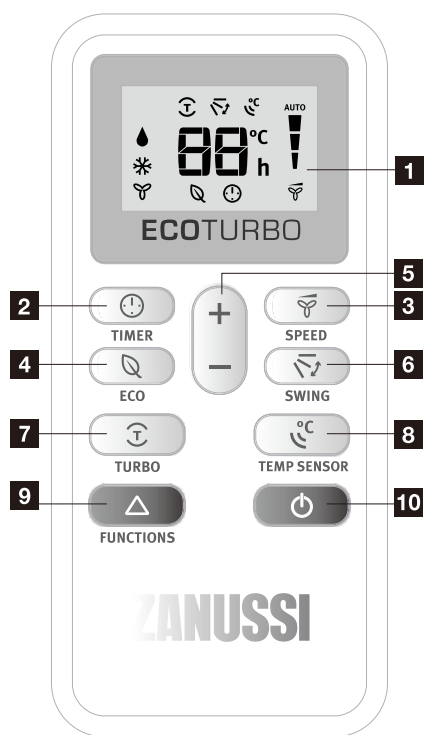

Cool models

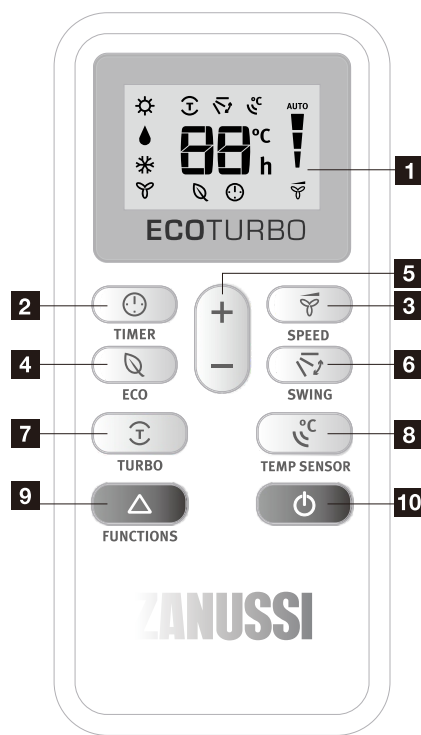

Heat and cool models

- 1 Remote Control viewer
- 2 Timer button
- 3 Fan speed button
- 4 Eco button
- 5 Temperature setting button

- 6 Swing button
- 7 Turbo button
- 8 Temp sensor button
- 9 Functions button
- 10 On/Off button

Note: The Follow me sensor is located on the back of the remote control.

Correct use of the remote control

Point the remote control to the receiver of the device. The maximum distance range between the remote and the unit is 7 meters (without obstacles between the remote and the receiver. Battery low can decrease the efficiency of the remote control.

The remote control must be tampered with care. Do not collapse, and never leave it exposed to direct contact from sunlight or heat sources.

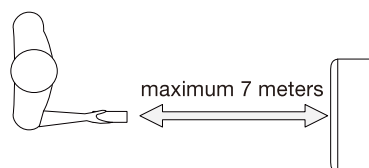

Placing or replacing the battery

1. Remove the cover on the back of the remote control.
2. Place 2 R03 AAA 1.5 V batteries in the correct position (see instructions inside the battery compartment).
3. Replace the cover.

If the remote control is replaced or discarded, the batteries must be removed and discarded and sent to collection stations to prevent damage to the environment.

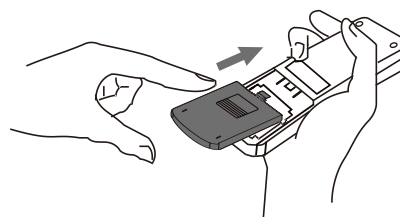



Programming through the remote control

Programming the device with the remote control equals programming via the control panel of the device.

See programming instructions through the control panel to set your air conditioning on the pages 13, 14, 15, 16, 17, 19, 19, 20 and 21.

Self-Diagnosis

This appliance has a self-diagnosis system to identify possible failures. See what to do if one of the error codes continues to appear in the control panel display of the device

Error code	What to do
 Defrost (Freeze prevention)	The device has a protection against freezing to avoid excessive icing. The device automatically turns on when the defrosting process ends.
 Sensor failure (damaged sensor)	If this error occurs, contact the Authorized Service of Zanussi

Tips for proper use of the device

For best performance of your device, follow these recommendations:

Close the doors and windows of the environment where the appliance is installed (Figure 1).

Protect the environment from direct contact from sunlight using curtains or blinds (Figure 2).

Never leave any object on the apparatus.

Do not block the air inlets and outlets (Figure 3). Let the grids free.

Certify that the device is supported on a flat floor. If necessary, support the front wheels on the pads supplied to prevent slipping.

Do not leave the product in contact with the wall or other object during use.

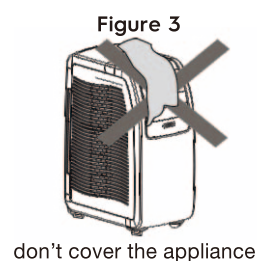
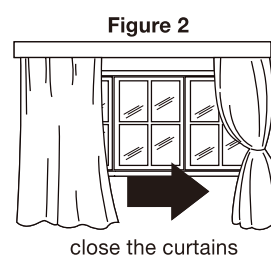
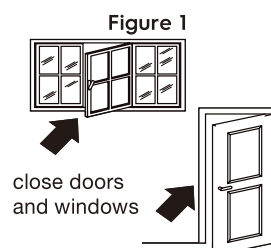

Cleaning and maintenance

Never clean your air conditioning with cleaning agents such as alcohol, kerosene, gasoline, bleach, solvents, acids, vinegar, abrasive or other chemicals not recommended in this manual.

Before starting the cleaning or maintenance, turn the appliance off by pressing the On/Off button on the control panel or remote control, wait a few minutes and then remove the plug from the power outlet.



Cleaning the outside

To clean the outside, use a damp cloth and dry it with a clean cloth. Do not use steel wool, abrasive powders or corrosive substances which may cause hazards.

Never pour water on the Air Conditioning.

Cleaning air filters

The air filtration system is composed of three filters:

Ultrafilter: retains up to 99% of bacteria*.

Nylon filter: removes dust and other solid particles.

Activated carbon filter: removes odors from the air that passes through it.

When the air filters become dirty, reduce product performance, so clean them once a month or if necessary more often. The filters are housed in the lower rails of the apparatus.

**Tested in Escherichia coli and Staphylococcus aureus bacteria*

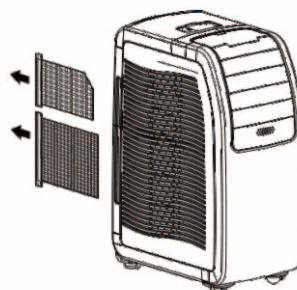
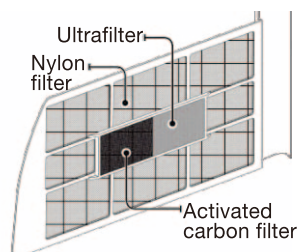

To avoid risks to your safety, machine damage and noise; do not use the air conditioning without filters.

Do not obstruct the air inlet of the product.

Cleaning the drain filter

The Heat and Cool models has a water filter, to prevent clogging of the drain pump due to impurities that may arise in the tank. It is recommended that this filter cleaning is performed every 2000 hours. Or every time the alarm "Change Filter" lights. This time may vary depending on the conditions of use of the device.

The water filter clogged can cause failures in the device, such as low flow or interruption of drainage pump, Empty alarm, or noise in the pump. The cleaning of the filter must be done by a trained professional, and is not covered by warranty

Start-End of the Useful life

Checks when you start using the device:

Make sure the power cord and plug are not damaged and the outlet is properly grounded.

Follow the installation instructions properly.

Procedures to follow before storing the appliance:

Drain all water in a bowl and replace the drain cover.

Clean the filters and dry thoroughly before reinstalling.

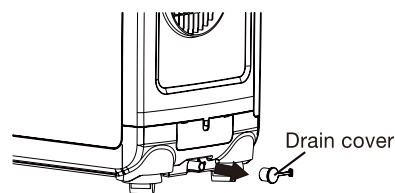

27 cleaning and maintenance

Drop formation

After some time of use, the surfaces of the apparatus are cooler than the ambient air. This temperature difference can cause condensation. This phenomenon is perfectly normal.

1. Internal Grids: Adjust so that they are straight, aligned with the air flow in the zero angle position. This adjustment can be made with hands.
2. Swing function On: Keep external oscillating louvers automatically through the Swing function.

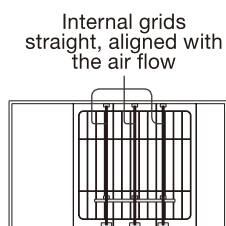
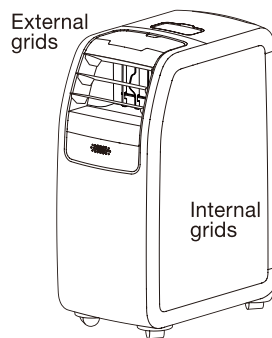

How to move it

Your Portable Air Conditioner has swivel wheels that allow movement in all directions.

To move it, we recommend pushing the appliance for the upper back.

So Air Conditioning damage is avoided, do not move the cable pulling force or pushing the front (through the vents).

If you need to erect it, use the carrying handles located at the front and at the back.

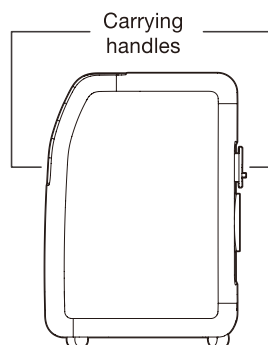

Troubleshooting

If your air conditioning experience usage problems, see the probable causes and solutions. If the suggested corrections are not enough contact the Zanussi Authorized Service Centre.

Failure	Causes	Solutions
The air conditioning does not work (no turn ON)	Switch turns off or power failure. The power cord is not plugged into the outlet. The internal safety device was powered.	Turn the switch ON or wait for the return of energy. Connect the plug into the outlet. Wait 30 minutes. If the problem persists, contact the Zanussi Authorized Service Centre.
The air conditioning works for a short time	The exhaust pipe is bent. Something is blocking the air outlet.	Position the exhaust pipe properly, keeping it as short as possible and without bends to prevent strangulation. Unblock the air outlet.
The air conditioning works, but does not cool the room.	Doors, windows and / or curtains open. There are heaters in the room (oven, hairdryer, etc.) The exhaust pipe is not connected to the appliance. The technical specification of the apparatus is not suitable for the environment in which it is located.	Close doors, windows and curtains. Remove the heaters of the environment. Connect the exhaust pipe to the appliance.
Strange smell in the air during the use of the device	Clogged filter.	Clean the filter under the Cleaning and Maintenance Chapter.
There is no operation for 3 minutes after restart	The compressor safety device prevents the product from running again until three minutes have elapsed since it was off.	Wait, this delay is normal and is part of the use of the apparatus.
Error code appears dF or - -	The device has a self-diagnosis system.	Check the item Self-Test on this user manual.
The remote control does not work	The control is more than 7 meters of the appliance. The batteries are worn or misfits. Strong light touch on the remote control.	The maximum range between the remote and the unit is 7 meters. Replace batteries or click them correctly on the remote control. Leave the remote in a place where there is no direct contact with light.

29 troubleshooting

Failure	Causes	Solutions
Other devices are turned on, off or change function when the remote is in use.	Interference between remotes	Separate the devices from one another during operation
The air conditioning is on, off or changes the remote control function when another device is in use.	Interference between remotes	Separate the devices from one another during operation.
Error alert “!” flashing on the control panel	The device was turned off in the wrong voltage	Check the voltage of the device on the label next to the plug of the power cord, and confirm if the outlet voltage is the same.

Technical specifications

Model	ZPM10CRA-D1	ZPM10HRA-D1
Color	White	White
Voltage-Frequency	220V~ /50Hz	220V~ /50Hz
Capacity-cool	10000Btu/h	10000Btu/h
Capacity-heat	-	8500Btu/h
Rated power-cool	1100W	1050W
Rated power-heat	-	1000W
Rated current-cool	4.9A	4.8A
Rated current-heat	-	4.6A
Refrigerant	R410A/560g	R410A/530g
Air flow volume	280-340m ³ /h	270-300m ³ /h
Dimensions	315x700x512mm	315x700x512mm
Weight	29kg	31kg

Model	ZPM12CRA-D1	ZPM12HRA-D1
Color	White	White
Voltage-Frequency	220V~ /50Hz	220V~ /50Hz
Capacity-cool	12000Btu/h	12000Btu/h
Capacity-heat	-	8500Btu/h
Rated power-cool	1200W	1350W
Rated power-heat	-	1200W
Rated current-cool	5.5A	5.9A
Rated current-heat	-	5.5A
Refrigerant	R410A/530g	R410A/530g
Air flow volume	300-320m ³ /h	280-340m ³ /h
Dimensions	315x700x512mm	315x700x512mm
Weight	30kg	31kg

31 notes

[illegible]

NOTES

33 notes

[illegible]

NOTES

